











# S19314 Series

## Combination Drench Shower and Halo™ Eyewash or Eye/Face Wash

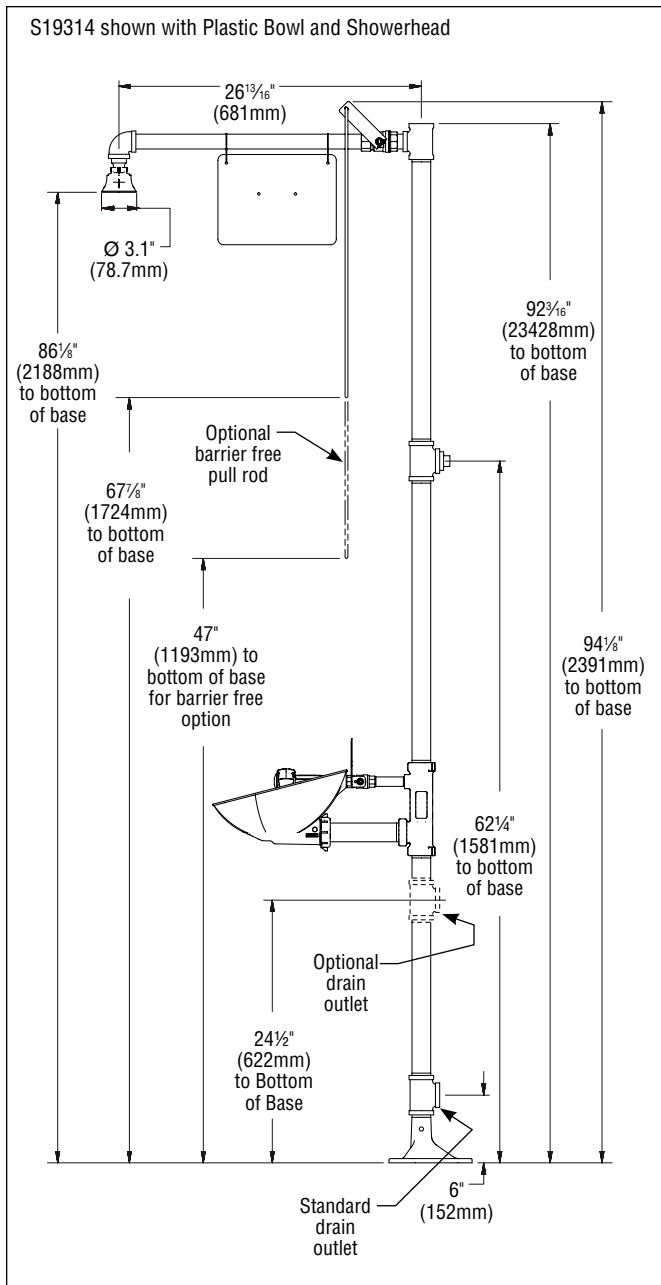

Plastic Showerhead with Plastic or Stainless Steel Shroud

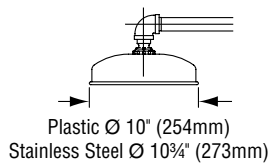

Type 304 and 316 Stainless Steel Showerheads

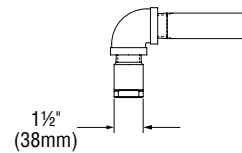

Eyewash Bowl

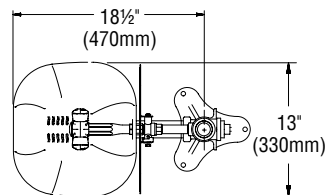

S19-430EH Drench Hose

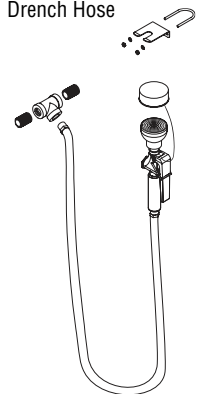

Dust Cover

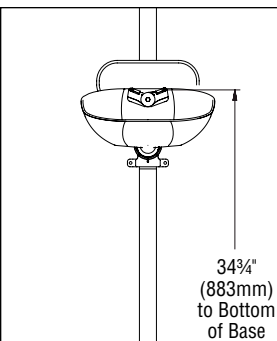
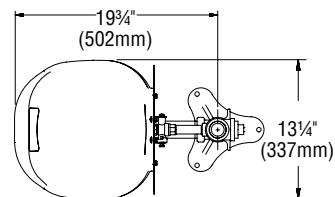

Foot Pedal Activation

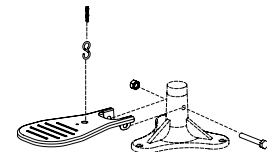

All dimensions assume standard thread engagement. Variations in manufacturing allow for +/- 1/8" (3mm) per threaded joint. To find the tolerance of a dimension, add the number of thread joints across the length of the dimension and multiply it by 1/8" (3mm).